

WESTERN COUNTY RECREATION CENTER

OCTOBER 7, 2024

Original Concept

- Began in 2009
- Concept plan was developed
- In 2011, accumulating funds were programmed into Poolesville's Capital Budget
- Dr. Dillingham was the site
- This plan was followed as the site added components such as the Skatepark and parking areas

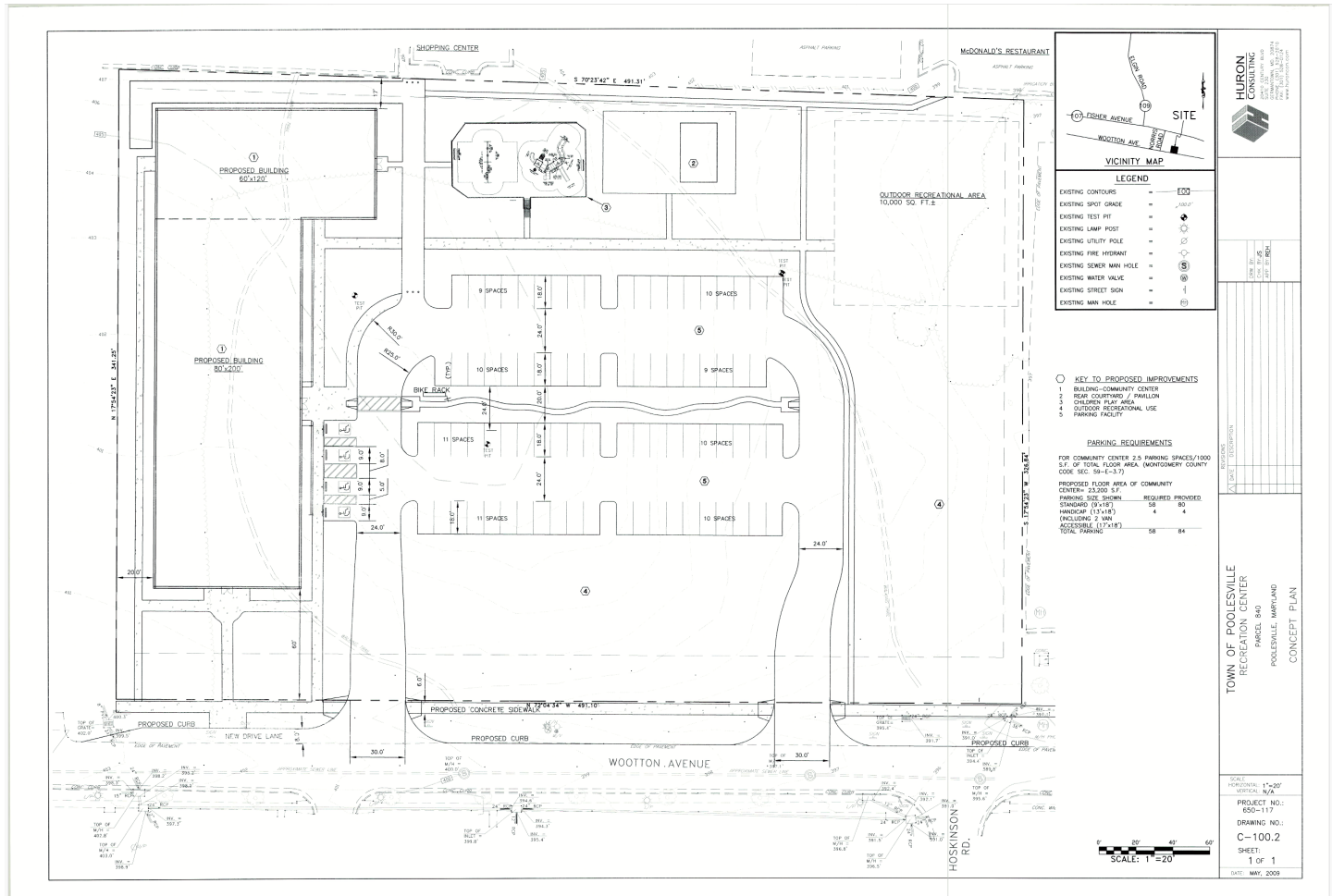

COMMUNITY SURVEY

Comprehensive Plan



Considering Poolesville's existing facilities, What new or additional facilities are needed?

Community Center 60%

Seasonable bubble for
County pool 46%

Multi-use trails 39%

FAIR ACCESS COMMITTEE

- In August of 2018, the Fair Access Committee released a white paper that outlined in detail the lack of equity in how the County treated the Western County and Poolesville regarding programs, services and facilities that are widely available to most county citizens
- During the High School construction lobbying efforts, a community center with clinical services as identified as a “real” need for the Town of Poolesville and surrounding area.
- The High School site was discussed but found not viable, for a variety of reasons.
- Fair Access and the Commissioners and residents continued pursuing the community center with the County Council and the County Executive.
- In 2022, the County budgeted for a Program of Requirements (POR)
 - Planning and guidance document
 - First step to getting construction funding
 - Includes what programming and facilities may be available





PROGRAM OF REQUIREMENTS

- Identified 18,000 square foot center
 - Gymnasium
 - Medical suite for health services
 - Community services
 - Programming for seniors
 - After school activities
 - Group meeting areas

CONSTRUCTION FUNDING

- In March The County Council Committees on Parks, Housing and Planning and Health and Human Services voted unanimously to approve funding for the proposed Western County Community Center and Health Care Clinic.
- \$15.5 million for the design and construction.
- Design phase 2028
- Construction phase 2029 - 2030



SITE SELECTION



Poolesville to partner
and provide site



All parks and County or
Town owned parcels
were considered



Total of 20 sites



Each site evaluated
using the County's
criteria

SELECTION CRITERIA

Buildable area

Proximate to Town Center

Pedestrian/Bicycle access

Vehicular access

Environmental Site Suitability

Existing amenities

Ownership

Opportunity for housing

Opportunity for childcare



TOP SITES

WHALEN COMMONS AND DR. DILLINGHAM PARK

NEXT STEPS



Task Parks Board with engaging the community for relocating the Dog Park (In process)



Introduce resolution showing intent to enter into agreement with the County to allow the use of Dr. Dillingham Park



Receive and consider public comment



Consider resolution adoption at the October 21st meeting.